

# Alacot<sup>®</sup> Max

## Olopatadine 0.7% Sterile Solution

Olopatadine is an inhibitor of the release of histamine from the mast cell and a selective histamine H1-antagonist that inhibits the in vivo and in vitro type 1 immediate hypersensitivity reaction including inhibition of histamine induced effects on human conjunctival epithelial cells.

### COMPOSITION

**Alacot<sup>®</sup> Max** Eye drops: Each ml contains Olopatadine 7 mg as Olopatadine HCl USP.

### INDICATION

**Alacot<sup>®</sup> Max** Eye Drops is indicated for the treatment of the signs and symptoms of allergic conjunctivitis.

### DOSAGE AND ADMINISTRATION

The recommended dose is one drop of the ophthalmic solution in the affected eye(s) once daily.

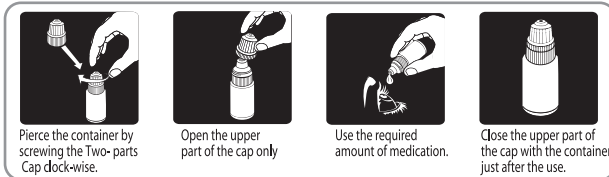

### CONTRAINDICATION

It is contraindicated in patients with known hypersensitivity to any ingredient of this formulation.

### WARNING & PRECAUTION

If signs of serious reactions or hypersensitivity occur, discontinue the use of this treatment. Patients who wear soft contact lenses should remove their lenses prior to instilling Olopatadine 0.7% ophthalmic solution and should wait at least 10 minutes after instillation of the eye drops.

### USE IN PREGNANCY AND LACTATION

**Use in Pregnancy:** There are no adequate and well-controlled studies in pregnant women. Olopatadine should be used in pregnancy only if the potential benefit justifies the potential risk to the fetus.

**Use in Lactation:** Olopatadine has been identified in the milk of nursing rats following oral administration. It is not known whether topical ocular administration could result in sufficient systemic absorption to produce detectable quantities in the human breast milk. Nevertheless, caution should be exercised when Alacot<sup>®</sup> Max is administered to a nursing mother.

### PEDIATRIC USE

The safety and effectiveness of **Alacot<sup>®</sup> Max** have been established in pediatric patients two years of age and older.

### GERIATRIC USE

No overall differences in safety or effectiveness have been observed between elderly and younger patients.

### SIDE EFFECT

Most common side-effects are blurred vision, dry eye, superficial punctate keratitis, dysgeusia and abnormal sensation in the eye.

### STORAGE

Store below 300C in a cool and dry place protected from light. Keep out of reach of children. Solution can be used up to 28 days after first opening.

### HOW SUPPLIED

**Alacot<sup>®</sup> Max** Eye drops: Each plastic dropper bottle contains 5 ml of Olopatadine Hydrochloride USP sterile solution

Manufactured by



**SQUARE**

**PHARMACEUTICALS LTD.**  
**BANGLADESH**